



# Meeting Facilities

## DOWNTOWN MEETING FACILITIES

### Adam's Mark Buffalo Niagara

120 Church Street • Buffalo, NY 14202 • (716) 854-5100 or (800) 444-2326 • Fax: (716) 854-5538 • www.adamsmark.com

- Buffalo's largest hotel featuring 72,000 square feet of meeting conference and convention space
- 486 newly redesigned sleeping rooms
- Non-smoking rooms available
- Variety of spacious suites
- Enclosed attached parking ramp
- In-house A/V capabilities with trained staff
- 257 seat DECO restaurant offers the finest in regional cuisine and Buffalo's best Sunday brunch
- Tiffany Rose Lounge features live music nightly
- Players sports bar offers big screen sports programming
- Health club, indoor pool and sauna
- 24 hour room service

ROOM	DIMENSIONS	THEATRE SEATING	CLASSROOM SEATING	BANQUET SEATING	SQUARE FEET
<b>FIRST FLOOR</b>					
Erie Ballroom	59' x 102'	850	400	500	6,018'
A&B or C&D	59' x 52'	420	160	240	3,068'
Erie Preconvene	23' x 94'	N/A	N/A	N/A	4,242'
Ontario Ballroom	34' x 75'	300	120	180	2,619'
A, B or C	34' x 25'	90	40	60	873'
A&B or B&C	34' x 50'	180	80	120	1,746'
Executive Boardroom	25' x 20'	N/A	N/A	N/A	500'
Fountain Room		425	200	350	
<b>THIRD FLOOR</b>					
Grand Hall	71' x 154'	1,230	560	800	10,934'
Grand Ballroom	180' x 90'	1,880	1,130	1,370	16,200'
Grand Ballroom					
A, B, D, or E	60' x 45'	400	170	230	2,700'
Grand Ballroom					
A + B, C Or D + E	60' x 90'	750	360	450	5,400'

ROOM	DIMENSIONS	THEATRE SEATING	CLASSROOM SEATING	BANQUET SEATING	SQUARE FEET
<b>Grand Ballroom</b>					
ABC or CDE	120' x 90'	1,230	750	900	10,800'
Grand Preconvene	196' x 43'	1,000	N/A	740	12,089'
Wright Room	58' x 39'	250	140	180	2,262'
Richardson Room	29' x 56'	180	110	130	1,595'
Sullivan Room	33' x 36'	140	80	100	1,188'
Olmsted Room	30' x 33'	N/A	N/A	N/A	990'
Directors Row I	14' x 35'	30	24	30	540'
Directors Row II	14' x 15'	20	8	10	210'
Directors Row III	14' x 22'	30	16	20	308'
Directors Row IV	14' x 28'	30	16	20	392'
Executive Boardroom	30' x 18'	N/A	N/A	N/A	540'
Preconvene D & E	29' x 91'	300	100	100	2,639'

# Adam's Mark Buffalo Niagara floor plans

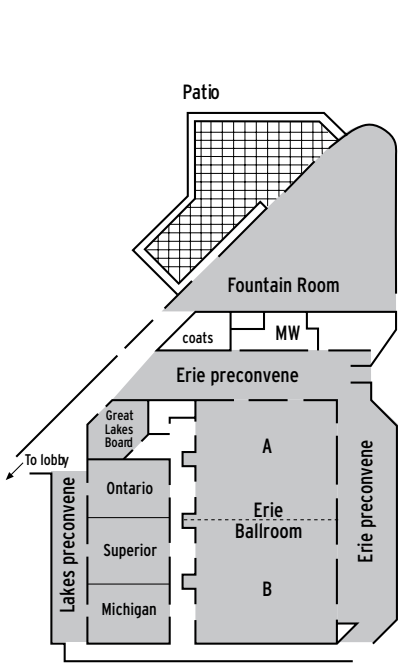

**First floor**

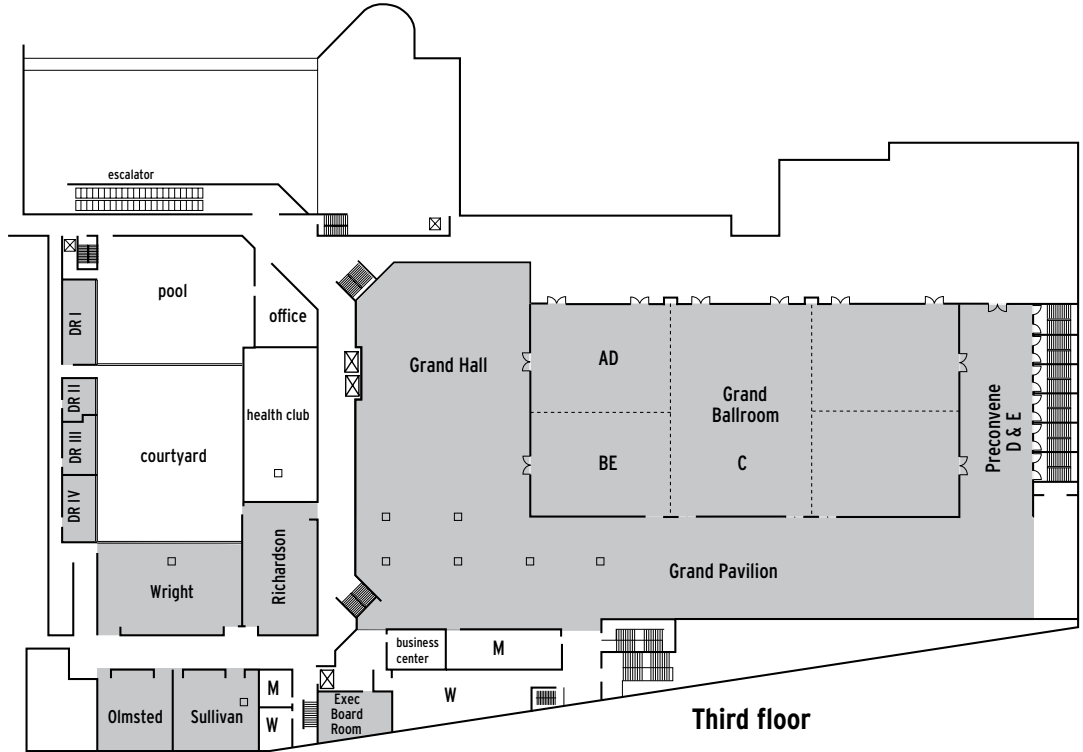

**Third floor**

## Albright-Knox Art Gallery

1285 Elmwood Avenue • Buffalo, NY 14222 • (716) 882-8700 • Fax: (716) 882-8773 • [www.albrightknox.org](http://www.albrightknox.org)

- The Albright-Knox Art Gallery offers an exquisite setting of art and architecture for a special, memorable event.
- Our buildings – one neoclassical, one modern – are the perfect location for a private party or corporate event, while the elegant, intimate spaces of AK café and the Sculpture Garden are ideal for meetings and special events.
- To enhance your experience at the Gallery, we offer audio tours and/or guided docent tours of the permanent collection and special exhibitions. The cost of this service is included in our usage fees. A guided docent tour beyond the 1962 Building may require a small additional security fee.
- For further information including pricing and other policies please refer to our website: [www.albrightknox.org](http://www.albrightknox.org)

ROOM	DIMENSIONS	THEATRE SEATING	CLASSROOM SEATING	BANQUET SEATING	SQUARE FEET
Auditorium	79' x 83'	350	N/A	N/A	6557'
AK Café	60' x 25'	80 for seated dinners, 100 for standing receptions			1500'
Clifton Hall	50' x 50'	225 Receptions, Concerts or Lectures, 190 Sit-down events with tables			2500'

## Asbury Hall at Babeville

341 Delaware Avenue • Buffalo, NY 14202 • (716) 852-3835 • Fax: (716) 852-2741 • [www.babevillebuffalo.com](http://www.babevillebuffalo.com)

- Handicap accessibility
- WiFi network
- Largest seating capacity: 800
- Banquet seating capacity: 250
- Parking lot with 40 spaces
- Baby grand piano
- On site kitchen
- 32' W x 16' D stage
- Two private dressing rooms

ROOM	DIMENSIONS	CONCERT CAPACITY	LARGEST SEATING CAPACITY	BANQUET SEATING	SQUARE FEET
<b>Asbury Hall</b>	<b>65' x 61'</b>	<b>1,200</b>	<b>800</b>	<b>250</b>	<b>3965</b>
ROOM	DIMENSIONS	THEATRE SEATING	CLASSROOM SEATING	BANQUET SEATING	SQUARE FEET
<b>Ninth Ward Lounge</b>	<b>23' x 42'</b>	<b>50</b>	<b>40</b>	<b>40</b>	<b>966</b>

## Asbury Hall at Babeville floor plan

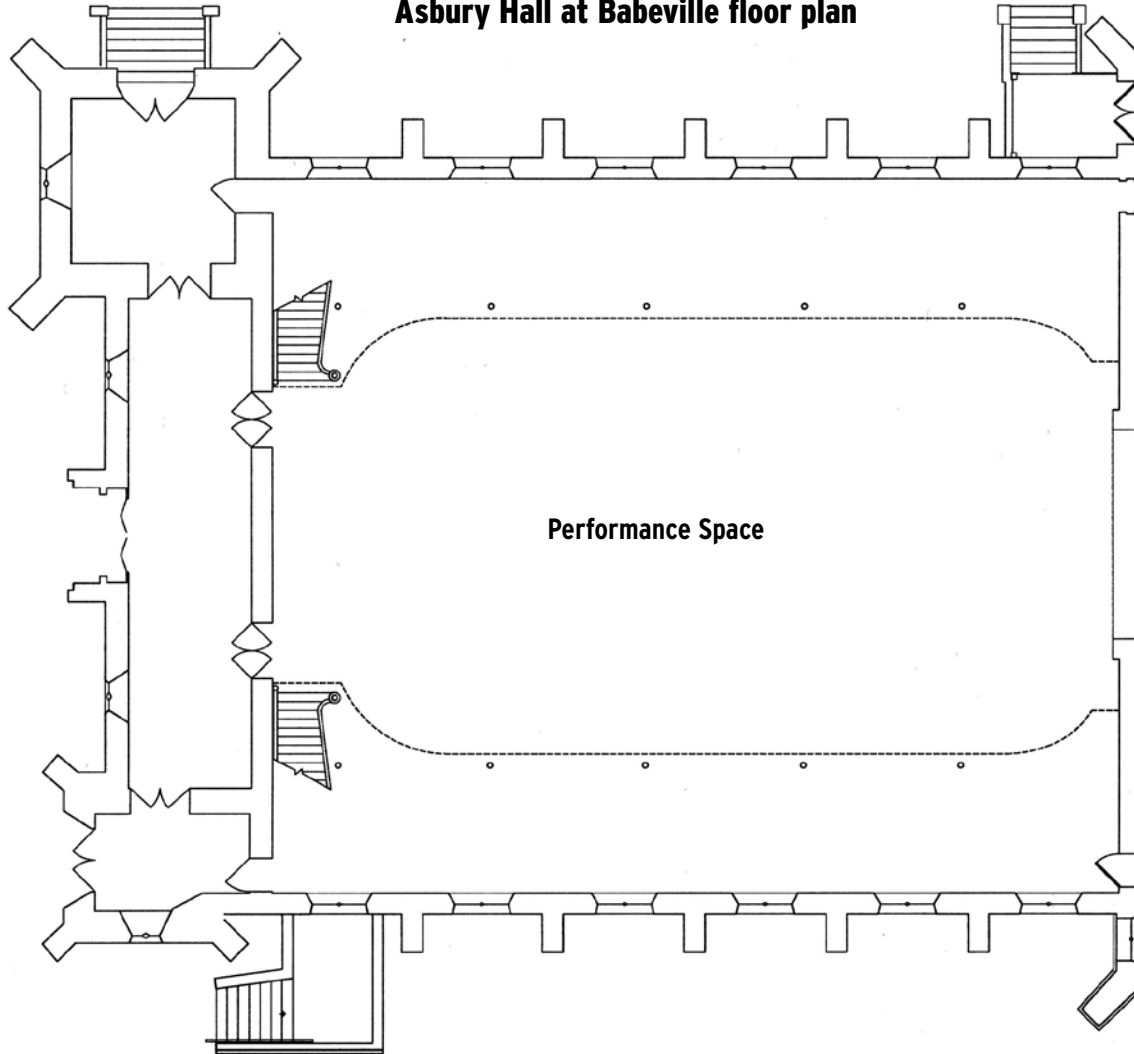

## Buffalo Conference Center

Six Fountain Plaza • Buffalo, NY 14202 • (716) 855-4800 • Fax: (716) 855-4828 • [www.buffaloconferencecenter.com](http://www.buffaloconferencecenter.com)

### Daily rate includes:

- Location adjacent to Hyatt Regency Buffalo Hotel
- Dedicated meeting coordinator
- Meeting room 7:00 am—6:00 pm
- High-speed Internet access
- State-of-the-art meeting facilities
- Wide range of food & beverage items & menus available
- Professional, friendly staff

- On-site audio visual Company

### Additional Options - Upgrades

- Additional menu upgrades, buffets and other options available!
- Parking validations available
- Overnight accommodations provided by the Hyatt Regency Buffalo (Buffalo Conference Center rate)
- Video conferencing available

ROOM	SQUARE FOOTAGE	THEATRE SEATING	CLASSROOM SEATING	BANQUET SEATING	U-SHAPE	CONFERENCE
BCC-B	1,103	64	36	48	29	34
BCC-B1	153	N/A	N/A	N/A	N/A	10
BCC-G	1,178	100	50	80	45	50
BCC-H	656	24	12	24	N/A	16
BCC-J	598	38	21	24	25	22
BCC-K	540	38	21	24	25	22
BCC-L	198	N/A	N/A	N/A	N/A	12

## **Buffalo Conference Center meeting package**

- Ergonomic seating with swivel & tilt: 8 hour comfort rating
  - Boardroom tables
  - Specialized lighting that maximizes the room's natural light
  - State-of-the-art audio/visual equipment
  - Video conferencing capabilities
  - High speed Internet access
  - Breakfast, lunch and dinner services provided by the Hyatt Regency Hotel
  - Location in the heart of the Financial District, adjoining the Hyatt Hotel Complex
  - Tackable wall surface
  - Staffed by skilled conference attendants
  - Separate dining facilities
  - Convenient parking
- \* *Overnight packages also available*

# Buffalo Niagara Convention Center

153 Franklin Street • Buffalo, NY 14202 • (716) 855-5555 or 800-995-7570 • Fax: (716) 855-3158 • [www.buffaloconvention.com](http://www.buffaloconvention.com)



- \$7 million in renovations to exhibit hall, kitchen, marquee and main entrance, completed September 2010
- 110,000 total square feet of flexible meeting and exhibit space accommodating conventions, meetings, trade shows, special events, weddings and more
- 64,410 square foot column-free exhibit hall that is divisible into two halves
- 21 Meeting and Breakout Rooms including a 12,367 square foot Ballroom
- In-House food & beverage offering a first-class dining experience
- Outstanding customer service
- In-House inventory of equipment available including: staging, tables, chairs, podiums, microphones, public address system
- Centrally located in the heart of downtown Buffalo
- High speed internet access available
- Connected to the Hyatt Regency via an enclosed walkway and within walking distance of downtown hotels
- Buffalo Green Hospitality partner

EXHIBITION SPACE	MAXIMUM NUMBER OF 10' X 10' BOOTHS	LARGEST SEATING CAPACITY	BANQUET SEATING
64,410'	350	7,000	4,000

ROOM	DIMENSIONS	THEATRE SEATING	CLASSROOM SEATING	BANQUET SEATING	SQUARE FEET
Exhibit Hall	160' x 392'	7,000	3,500	4,000	64,410'
Ballroom	149' x 83'	1,400	800	1,000	12,367'
101	142' x 92'	1,360	680	930	13,064'
101A	29' x 48'	150	72	100	1,392'
101B	40' x 48'	200	100	140	1,920'
101C	44' x 48'	200	100	140	2,112'
101D	29' x 48'	150	72	100	1,392'
101E	29' x 44'	130	68	90	1,276'
101F	44' x 44'	200	100	140	1,936'
101G	40' x 44'	200	100	130	1,760'
101H	29' x 44'	130	68	90	1,276'
102	18' x 30'	50	24	40	540'

ROOM	DIMENSIONS	THEATRE SEATING	CLASSROOM SEATING	BANQUET SEATING	SQUARE FEET
103	28' x 29'	80	48	60	812'
104	28' x 29'	80	48	60	812'
105	18' x 30'	50	24	40	540'
106	79' x 96'	750	392	540	7,584'
106A	41'6" x 48'	200	100	140	1,992'
106B	37'6" x 48'	175	96	130	1,800'
106C	37'6" x 48'	175	96	130	1,800'
106D	41'6" x 48'	200	100	140	1,992'
107	18' x 31'	50	24	40	558'
108	28' x 29'	80	48	60	812'
109	28' x 29'	80	48	60	812'
Boardroom	18' x 31'	20 <i>(Boardroom Seating)</i>	N/A	N/A	558'
Cocktail Lounge	14' x 77'	N/A	N/A	N/A	1,078'
Lobby	146' x 60'	N/A	N/A	N/A	8,760'

# Buffalo Niagara Convention Center floor plans

Exhibit floor

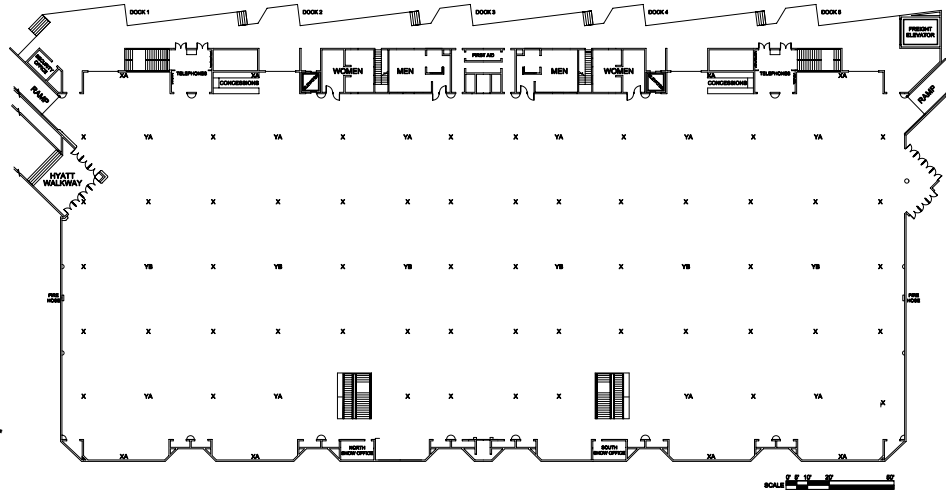

Marquee level

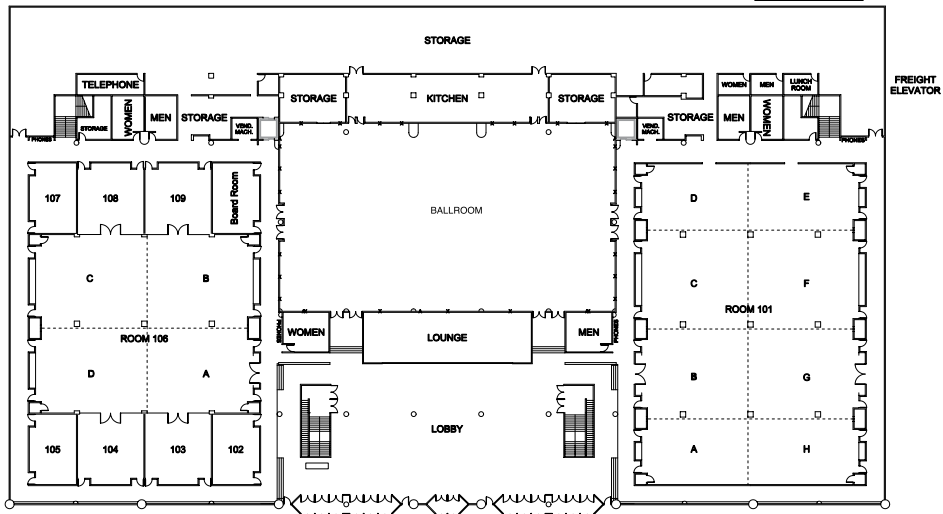

## Embassy Suites Buffalo

200 Delaware Avenue • Buffalo, NY 14202 • (716) 842-1000 or 800-EMBASSY • Fax: (716) 886-7942 • [www.buffalo.embassysuites.com](http://www.buffalo.embassysuites.com)



- 153 guest rooms
- 7 meeting rooms
- Largest seating capacity: 250
- Banquet seating capacity: 200
- Airport transportation available
- Bar and restaurant on site
- Health club on site
- Drop-down screens in each meeting room
- Fixed boardroom table that seats 14 in executive chairs
- Patio outside Avant Ballroom for breaks and receptions
- Large glass windows in all rooms that can be open for light or closed for AV presentations
- Large open area by Encore Ballroom suitable for coffee breaks and luncheons

ROOM	DIMENSIONS	THEATRE SEATING	CLASSROOM SEATING	BANQUET SEATING	SQUARE FEET
<b>FIRST FLOOR</b>					
Avant Ballroom	45' x 83'	250	200	200	3,735'
Avant Ballroom I	45' x 34'	80	50	75	1,530'
Avant Ballroom II	45' x 25'	80	50	75	1,125'
Avant Ballroom III	45' x 24'	90	60	80	1,080'
Avant Ballroom I & II	45' x 59'	150	100	150	2,655'
Avant Ballroom II & III	45' x 49'	160	100	160	2,205'

ROOM	DIMENSIONS	THEATRE SEATING	CLASSROOM SEATING	BANQUET SEATING	SQUARE FEET
<b>SECOND FLOOR</b>					
Encore Ballroom	29' x 74'	150	120	130	2,146'
Encore Ballroom I	29' x 23'	50	32	48	667'
Encore Ballroom II	29' x 25'	45	36	44	725'
Encore Ballroom III	29' x 25'	45	32	44	725'
Encore Ballroom I & II	29' x 48'	85	55	85	1,392'
Encore Ballroom II & III	29' x 50'	85	55	85	1,450'

# Embassy Suites Buffalo floor plans

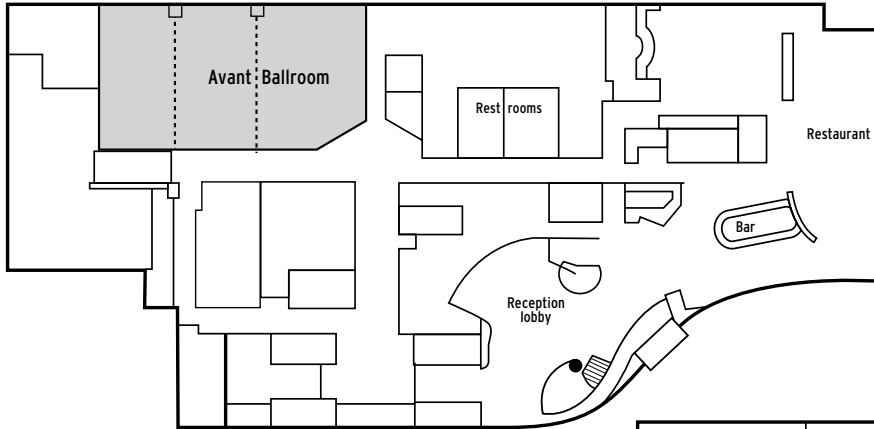

First floor

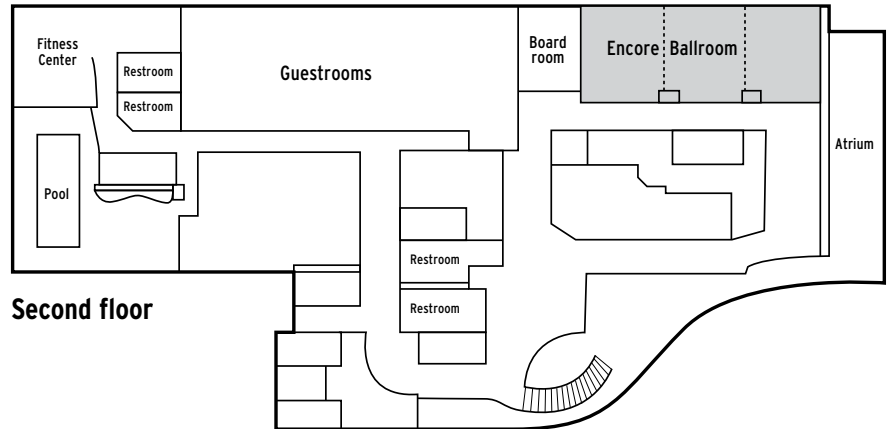

Second floor

## Holiday Inn Buffalo Downtown

620 Delaware Avenue • Buffalo, NY 14202 • (716) 886-2121 • Fax: (716) 886-7942 • [www.hibuffalodowntown.com](http://www.hibuffalodowntown.com)

- 168 sleeping rooms
- Minutes from HSBC Arena and Buffalo Niagara Convention Center
- Meeting and catering facilities for 10-250 people
- Data ports in each room and free incoming faxes
- Wireless high-speed Internet access throughout hotel
- Heated outdoor pool and fitness room
- Grille 620 on-site
- Complimentary 24-hour airport shuttle
- Free parking
- Cable programming includes free HBO and ESPN, CNN, TNT and TBS

ROOM	DIMENSIONS	THEATRE SEATING	CLASSROOM SEATING	BANQUET SEATING	SQUARE FEET
Delaware Ballroom	57' x 74'	400	N/A	275	4,218'
Franklin	37' x 19'	70	30	50	703'
Niagara	36' x 33'	80	40	60	1,188'
Virginia	24' x 19'	30	15	30	456'
Lafayette	38' x 33'	80	40	70	1,254'
Franklin & Virginia	61' x 19'	100	50	90	1,159'
Niagara & Lafayette	69' x 33'	225	80	150	2,277'

## Holiday Inn Buffalo Downtown floor plan

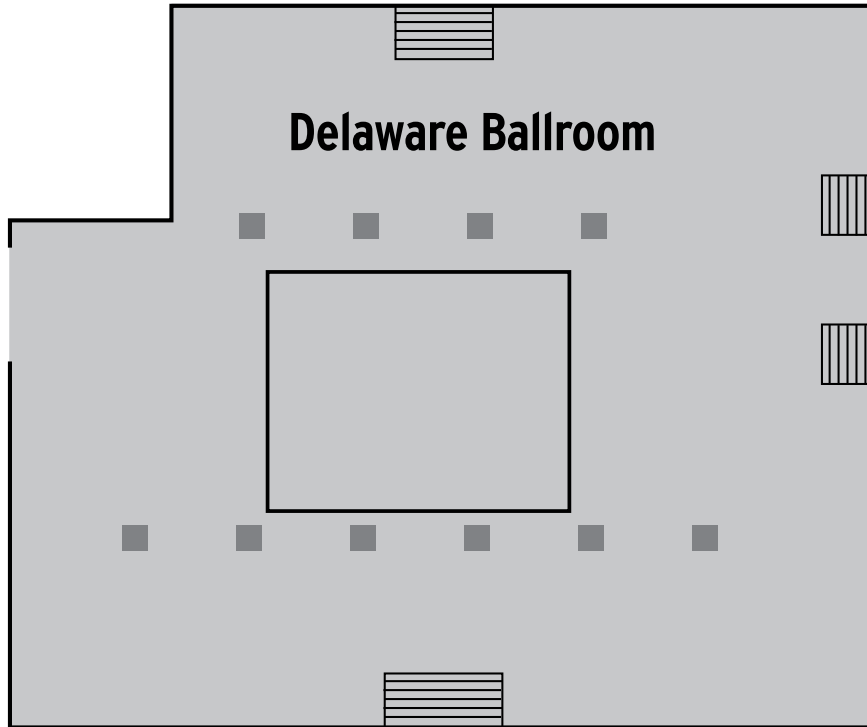

# Hyatt Regency Buffalo

Two Fountain Plaza • Buffalo, NY 14202 • (716) 856-1234 • Fax: (716) 852-6157 • [www.buffalo.hyatt.com](http://www.buffalo.hyatt.com)



- 396 newly renovated, spacious guestrooms
- Luxurious Hyatt grand beds/flat screen televisions/deluxe granite baths
- Generous work area with ergonomic chairs/high speed internet
- Beautifully re-designed suites/executive corner kings/eat & tweet rate
- 24-hour Business Center/Wi-Fi in public areas
- Gift Shop/E-Concierge
- Climate controlled pedestrian walkway to Buffalo Niagara Convention Center
- Award winning E.B. Green's Steakhouse
- Atrium Bar and Bistro
- In-room Dining
- Live Piano entertainment in our Atrium and in E.B. Green's Steakhouse
- 24 hour Hyatt StayFit fitness center
- Yoga Away, a unique yoga experience
- 21,352 square feet of flexible, newly renovated meeting and banquet space
- Connected to the Buffalo Niagara Convention Center and the Buffalo Conference Center
- Creative catering for on site and off-premise events
- Wedding and event specialists on staff, Kosher catering services available
- Rooftop indoor pool featuring panoramic views
- Spa Alexis, a full-service onsite spa

ROOM	THEATRE DIMENSIONS	CLASSROOM SEATING	BANQUET SEATING	SEATING	SQUARE FEET
<b>MEZZANINE LEVEL</b>					
<b>Grand Ballroom</b>	135' x 75'	1,480	890	910	10,125'
Section A	75' x 37'	320	170	210	2,775'
Section B	50' x 46'	250	140	160	2,300'
Section C	46' x 25'	100	60	80	1,150'
Section D	75' x 13'	N/A	N/A	N/A	975'
Section E	37' x 25'	80	54	60	925'
Section F	37' x 25'	80	54	60	925'
Section G	37' x 25'	80	54	60	925'
<b>Regency Ballroom</b>	93' x 33'	300	180	210	3,060'
Section A	33' x 31'	100	54	50	1,020'
Section B	33' x 31'	100	54	50	1,020'
Section C	33' x 31'	100	54	50	1,020'

ROOM	THEATRE DIMENSIONS	CLASSROOM SEATING	BANQUET SEATING	SEATING	SQUARE FEET
<b>SECOND LEVEL</b>					
<b>Niagara</b>	29' x 20'	50	24	40	580'
<b>Seneca</b>	17' x 16'	20	15	20	272'
<b>Franklin</b>	25' x 15'	35	18	30	375'
<b>Ellicott</b>	30' x 24'	70	28	60	720'
<b>Delaware Suites</b>	52' x 33'	130	72	90	1,700'
Section A	33' x 14'	30	18	20	460'
Section B	33' x 22'	40	22	30	725'
Section C	33' x 14'	30	18	20	460'
<b>Executive</b>	23' x 17'	12 (conference)	N/A	N/A	390'
<b>Boardroom</b>	30' x 18'	26 (conference)	N/A	N/A	540'
<b>AUXILIARY SPACE</b>					
<b>Sun Garden</b>				60	
<b>Atrium Bar &amp; Bistro</b>				150	

# Hyatt Regency Buffalo floor plans

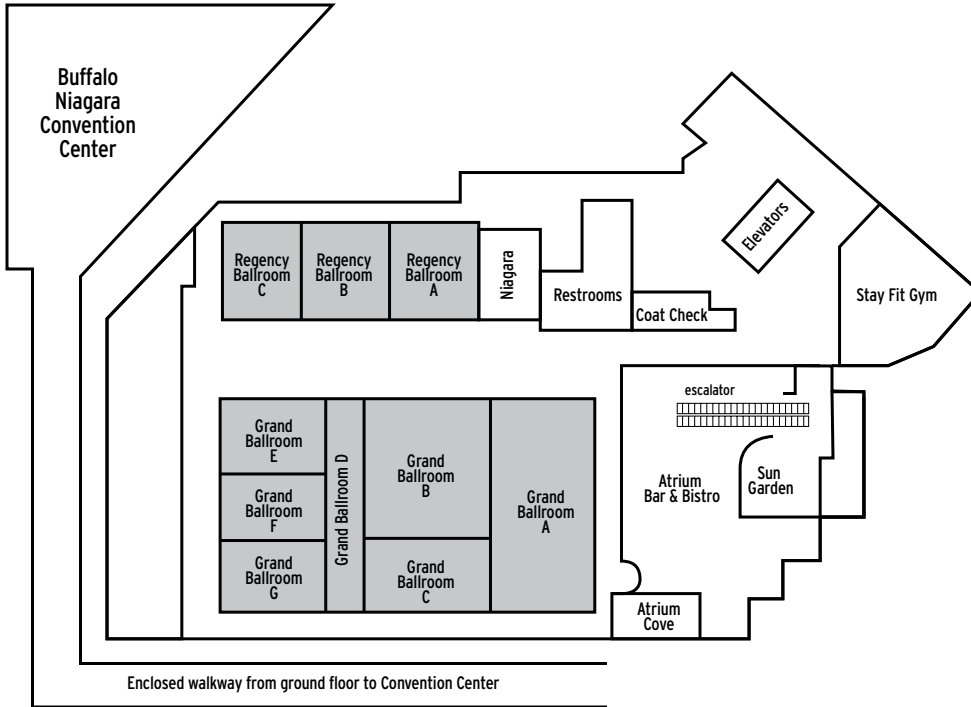

**First Floor**

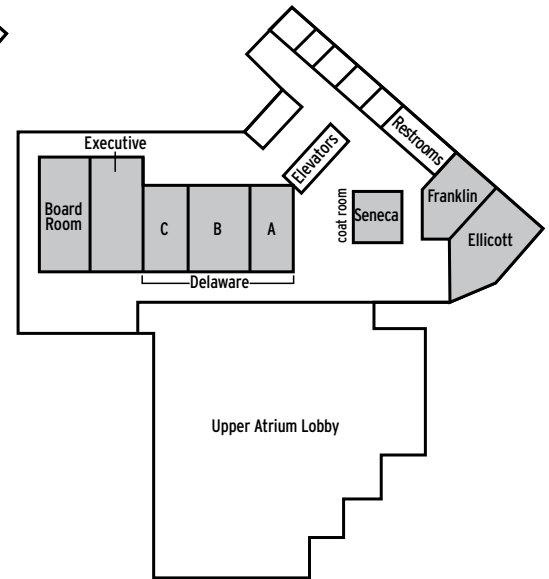

**Second Floor**

## Shea's Performing Arts Center

646 Main Street • Buffalo, NY 14202 • (716) 847-1410 • Fax: (716) 852-6004 • [www.sheas.org](http://www.sheas.org)

---

- Nationally recognized historic landmark
- Interior was designed by Tiffany and is continually restored to its original grandeur

ROOM	THEATRE SEATING	COCKTAIL RECEPTION	BANQUET SEATING
Shea's Smith Theatre	200	200	120
Grand Lobbies		500	180
Main Stage	3,019	500	300 with dance floor 400 without dance floor
Shea's Intermission Lounge	N/A	100	70

# Shea's Performing Arts Center floor plans

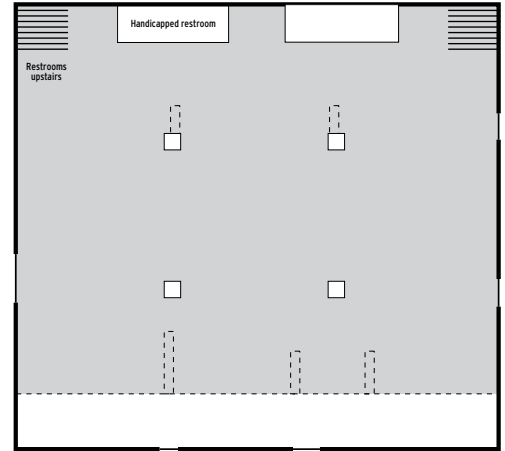
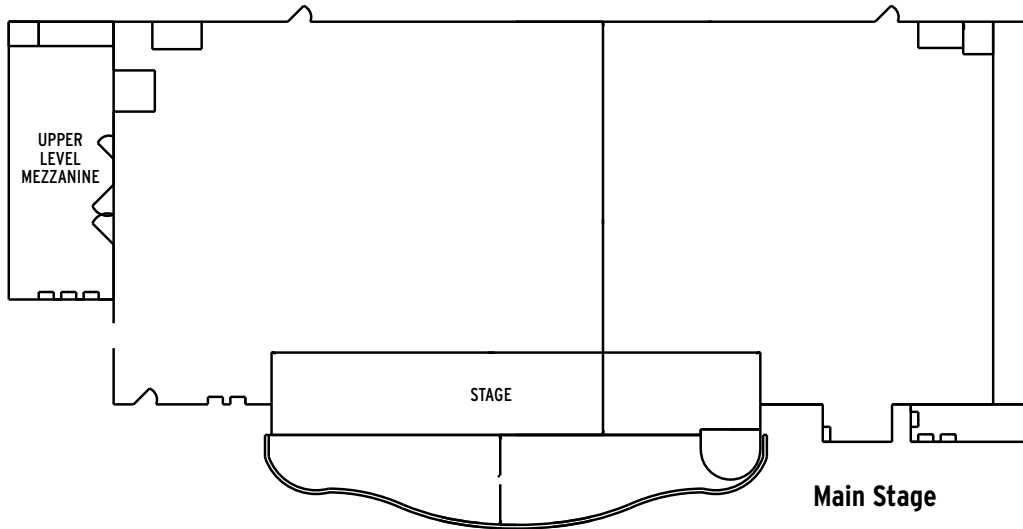

**Smith Theater**

## SUBURBAN MEETING FACILITIES

### Buffalo Niagara Marriott

1340 Millersport Highway • Amherst, NY 14221 • (716) 689-6900 • Fax: (716) 689-0483 • [www.buffaloniagaramarriott.com](http://www.buffaloniagaramarriott.com)

- 356 sleeping rooms
- Directly adjacent to University at Buffalo, 20 minutes from downtown
- 8,112 square foot ballroom, divisible into five sections, accommodates up to 1,000 for receptions and 600 for banquets
- 10 smaller meeting rooms for 25-250 people
- 120 8' x 10' exhibit booths can be accommodated
- Beautiful outdoor courtyard for themed parties and other functions
- Spacious parking
- Indoor/outdoor pool, whirlpool, sauna, exercise room and game room
- Houlihan's Restuarant & Bar, creative food and drinks
- Rent cars and vans right from the lobby

ROOM	DIMENSIONS	THEATRE SEATING	CLASSROOM SEATING	BANQUET SEATING	SQUARE FEET
Grand Ballroom	78' x 104'	800	500	600	8,112'
Ballroom I	22' x 34'	50	25	40	748'
Ballroom II	34' x 34'	90	60	80	1,156'
Ballroom III	22' x 34'	50	25	40	748'
Ballroom IV	78' x 34'	240	180	150	2,652'
Ballroom V	78' x 34'	240	180	150	2,652'

ROOM	DIMENSIONS	THEATRE SEATING	CLASSROOM SEATING	BANQUET SEATING	SQUARE FEET
Salon room A	26' x 25'	40	30	40	650'
Salon room B	26' x 25'	40	30	40	650'
Salon room C	24' x 26'	38	20	30	624'
Salon room D	24' x 25'	38	20	30	600'
Salon room E	24' x 36'	80	40	50	864'

## Buffalo Niagara Marriott floor plans

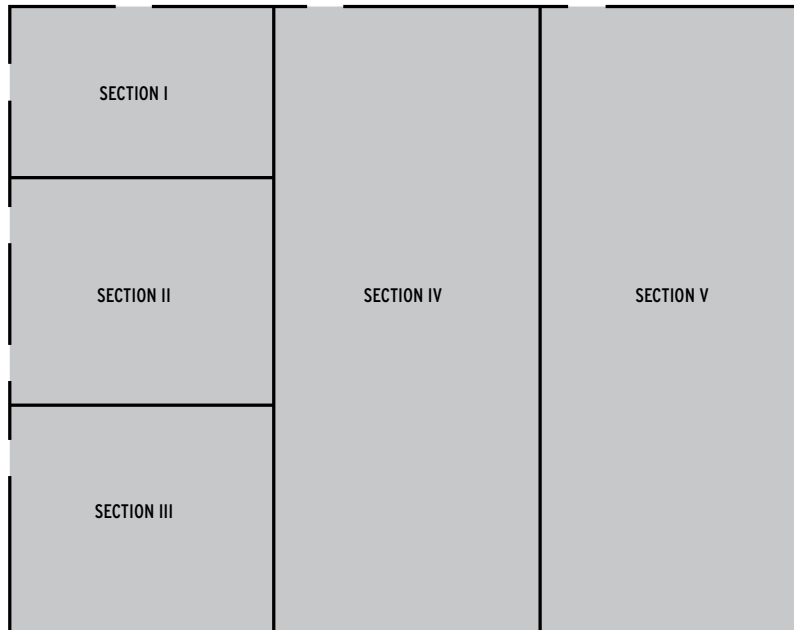

GRAND BALLROOM

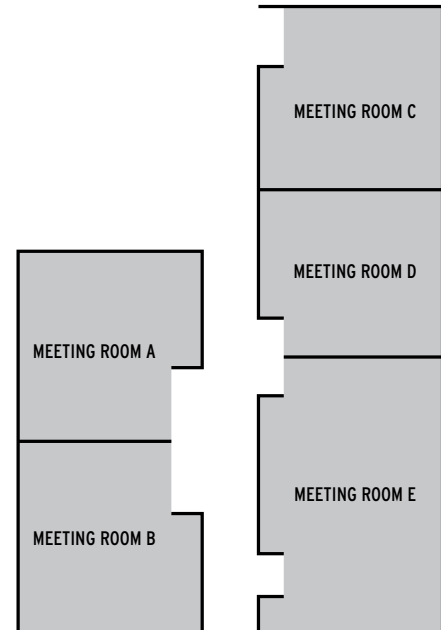

CONFERENCE SALONS

## Hearthstone Manor

333 Dick Road • Depew, NY 14043 • (716) 684-8850 • Fax: (716) 684-8853 • [www.hearthstonemanor.com](http://www.hearthstonemanor.com)

- Ideal for weddings, banquets, meetings, trade shows, showers, reunions, auctions and fund-raising dinners
- Catering to groups ranging from 20 to 2000 guests
- 16,000 square feet of elegant modular ballroom
- Largest parquet wood dance floor in Western New York
- High quality dining and beverage service at very affordable prices
- High speed internet access available
- Central location: 3 miles from NYS Thruway, 1 mile from the 33 Expressway, 2 miles from the Buffalo Airport

ROOM	DIMENSIONS	THEATRE SEATING	CLASSROOM SEATING	BANQUET SEATING	SQUARE FEET
Entire Facility	180' x 76'	1,600	600	1,400	13,680'
2 rooms (1 & 2 or 2 & 3)	120' x 76'	1,200	400	500	9,120'
1 room (1, 2 or 3)	60' x 76'	450	180	300	4,560'
Half Room	60' x 38'	300	100	100	2,280'
Kings Room	32' x 44'	90	45	80	1,408'
Queens Room	22' x 24'	40	25	40	528'

# Hearthstone Manor floor plan

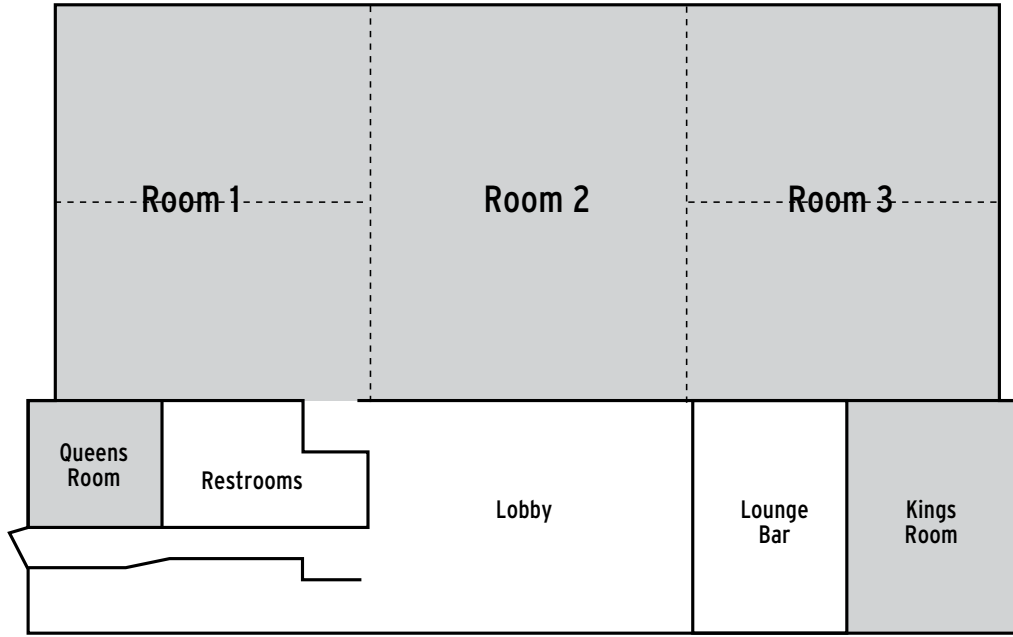

# Hilton Garden Inn Buffalo Airport

4201 Genesee Street • Cheektowaga, NY 14225 • (716) 565-0400 • Fax: (716) 565-0063 • hiltongardeninn.hilton.com



- 2,600 square feet of divisible meeting and banquet space to accommodate weddings and corporate events featuring pre-function space
- Exquisite outdoor courtyard with waterfall and seating area
- Executive boardroom with a flat screen television and select AV equipment
- Meeting facilities with flat screen television and select AV equipment
- 158 beautifully appointed guestrooms, including 43 suites
- Great American Grill restaurant is open for breakfast, lunch and dinner; daily dinner specials
- Room service available for dinner
- Beautiful indoor heated pool and whirlpool spa
- Fitness center with the latest cardio and weight equipment - each cardio machine features a personal TV
- Complimentary 24-hour business center
- Complimentary guest parking
- Complimentary high-speed Internet access and secure, remote printing to the business center
- Refrigerator, microwave and coffee maker in each room
- Large work desk with convenient desk-level outlets, adjustable lighting and ergonomic Mirra® chair by Herman Miller
- Hair dryer, iron and ironing board
- High-definition flat screen cable TV with pay movies and complimentary HBO
- Suites feature spacious living area and a single pull-out sofa bed

ROOM	DIMENSIONS	THEATRE SEATING	CLASSROOM SEATING	BANQUET SEATING	SQUARE FEET
Ballroom I	42' x 20'	75	36	60	840'
Ballroom II	42' x 20'	75	36	60	840'
Ballroom III	42' x 20'	75	36	60	840'

ROOM	DIMENSIONS	THEATRE SEATING	CLASSROOM SEATING	BANQUET SEATING	SQUARE FEET
Emerald Ballroom	42' x 60'	300	140	225	2,250'
Executive Boardroom	18' x 26'	50	20	40	468'

# Hilton Garden Inn floor plan

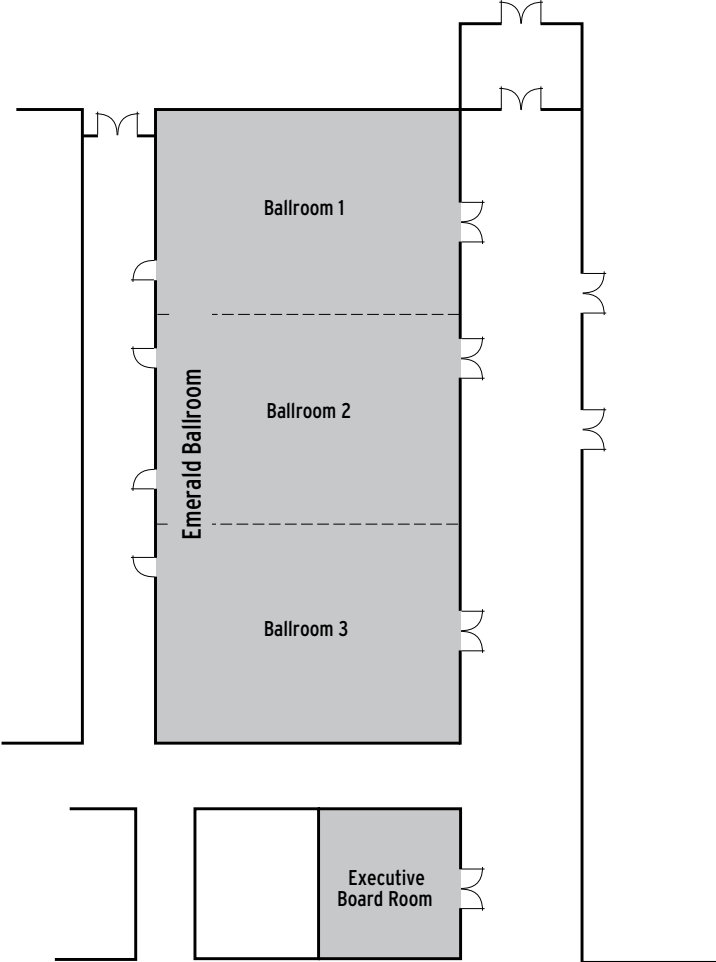

## Holiday Inn Buffalo Airport

4600 Genesee Street • Cheektowaga, NY 14225 • (716) 634-6969 • Fax: (716) 634-0920 • [www.hibuffaloairport.com](http://www.hibuffaloairport.com)

- 207 sleeping rooms and 4 deluxe suites
- Minutes from Walden Galleria mall
- Meeting and catering facilities for 10-250 people
- Data ports in each room and free incoming faxes
- Wireless high-speed Internet access throughout hotel
- Heated outdoor pool, jacuzzi and fitness center
- Max's Classic American Grill
- Complimentary 24-hour airport shuttle
- Free DirecTV satellite programming with multiple HBO channels and Music Choice

ROOM	DIMENSIONS	THEATRE SEATING	CLASSROOM SEATING	BANQUET SEATING	SQUARE FEET
<b>Independence</b>	<b>28' x 40'</b>	<b>85</b>	<b>40</b>	<b>60</b>	<b>1,120'</b>
<b>Commerce</b>	<b>20' x 40'</b>	<b>70</b>	<b>30</b>	<b>50</b>	<b>800'</b>
<b>Constitution</b>	<b>40' x 40'</b>	<b>150</b>	<b>80</b>	<b>100</b>	<b>1,600'</b>
<b>Liberty Ballroom</b>	<b>88' x 40'</b>	<b>300</b>	<b>200</b>	<b>300</b>	<b>3,520'</b>
<b>Boardroom</b>	<b>19' x 24'</b>	<b>40</b>	<b>15</b>	<b>30</b>	<b>456'</b>

## Holiday Inn Buffalo Airport floor plans

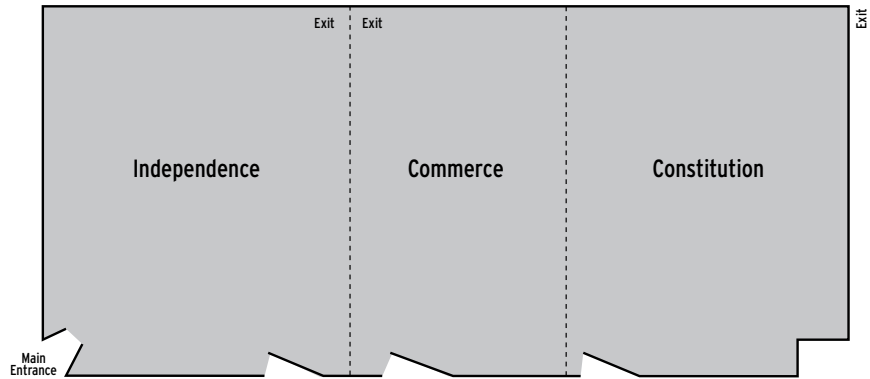
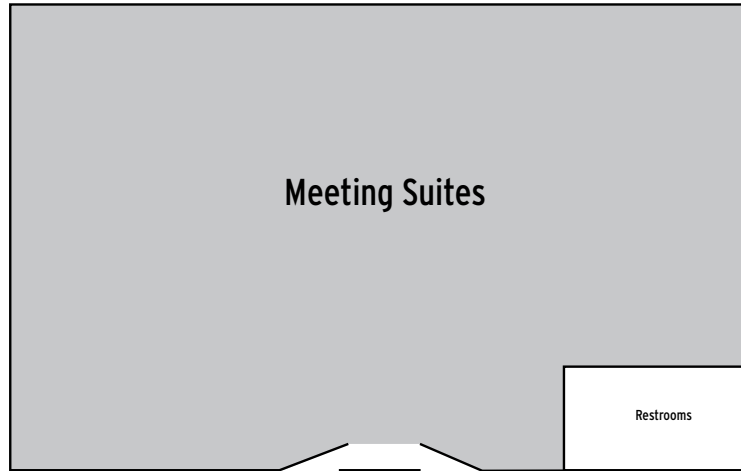

## Holiday Inn Buffalo Amherst

1881 Niagara Falls Boulevard • Amherst, NY 142258 • (716) 691-8181 • Fax: (716) 691-4965 • [www.hibuffaloamherst.com](http://www.hibuffaloamherst.com)

- 199 sleeping rooms
- Near University at Buffalo, Niagara Falls and shopping centers
- Meeting and catering facilities for 10-350 people
- Coffee makers, hair dryers and irons and boards in every room
- Data ports in each room and free incoming faxes
- Wireless high-speed Internet access throughout hotel
- Heated indoor pool, jacuzzi and fitness center
- Max's Classic American Grill
- Complimentary 24-hour airport shuttle

ROOM	THEATRE SEATING	CLASSROOM SEATING	BANQUET SEATING	SQUARE FEET
Grand Ballroom	400	200	300	3,663'
Huron Room	70	35	50	760'
Ontario Room	70	35	50	760'
Michigan Room	50	25	40	760'

ROOM	THEATRE SEATING	CLASSROOM SEATING	BANQUET SEATING	SQUARE FEET
Erie Room	35	20	30	480'
Superior Room	40	20	30	615'
Courtyard Room	25	16	20	433'
Niagara Room	20	N/A	10	288'

# Holiday Inn Buffalo Amherst floor plans

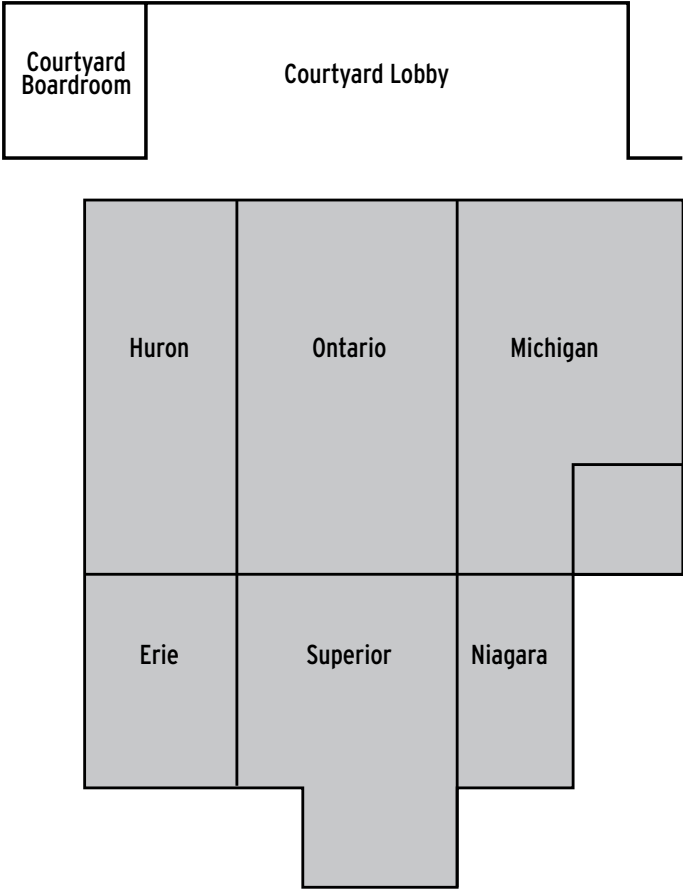

## Holiday Inn Grand Island Resort & Conference Center

100 Whitehaven Road • Grand Island, NY 14072 • (716) 773-1111 or 877-472-6310 • Fax: (716) 773-1229 • [www.myholidayinn.com](http://www.myholidayinn.com)

- 263 guest rooms
- 13 meeting rooms
- Largest seating capacity: 750
- Banquet seating capacity: 450
- Airport transportation available
- Bar and restaurant on site
- Health club on site, featuring treadmills, ellipticals, free weights and aerobics
- Indoor and outdoor swimming pools
- Full service resort and conference center, equidistant from Buffalo and Niagara Falls (10 minutes each)
- Featuring the Riverview ballroom, with an attached covered outdoor patio
- Located on the banks of the Niagara River in a park-like setting
- Adjacent to River Oaks Golf Course
- Home port of Grand Lady Cruises



ROOM	DIMENSIONS	THEATRE SEATING	CLASSROOM SEATING	BANQUET SEATING	SQUARE FEET
Senate Suite	45' x 66'	275	175	200	2,970'
Senate A	45' x 40'	150	100	120	1,800'
Senate B	38' x 26'	100	60	75	988'
Riverview	58' x 92'	150	120	280	5,336'
Patio	28' x 90'	N/A	N/A	N/A	
Caucus	28' x 29'	50	35	50	812'
West I	16' x 34'	30	20	50	544'
West II	16' x 34'	15	10	N/A	544'
Grand Ballroom	57' x 95'	750	350	425	5,415'

ROOM	DIMENSIONS	THEATRE SEATING	CLASSROOM SEATING	BANQUET SEATING	SQUARE FEET
East	57' x 35'	200	100	150	1,995'
Center	57' x 30'	200	100	145	1,710'
West	57' x 30'	200	100	145	1,710'
Stage	34' x 14'	N/A	N/	N/A	476'
Settlement Room	59' x 49'	250	150	200	3,770'
Currents	90' x 28'	200	100	200	2,520'
Regency	65' x 30'	150	100	120	1,950'
Niagara Room	80' x 60'	150	75	120	2,419'

# Holiday Inn Grand Island floor plans

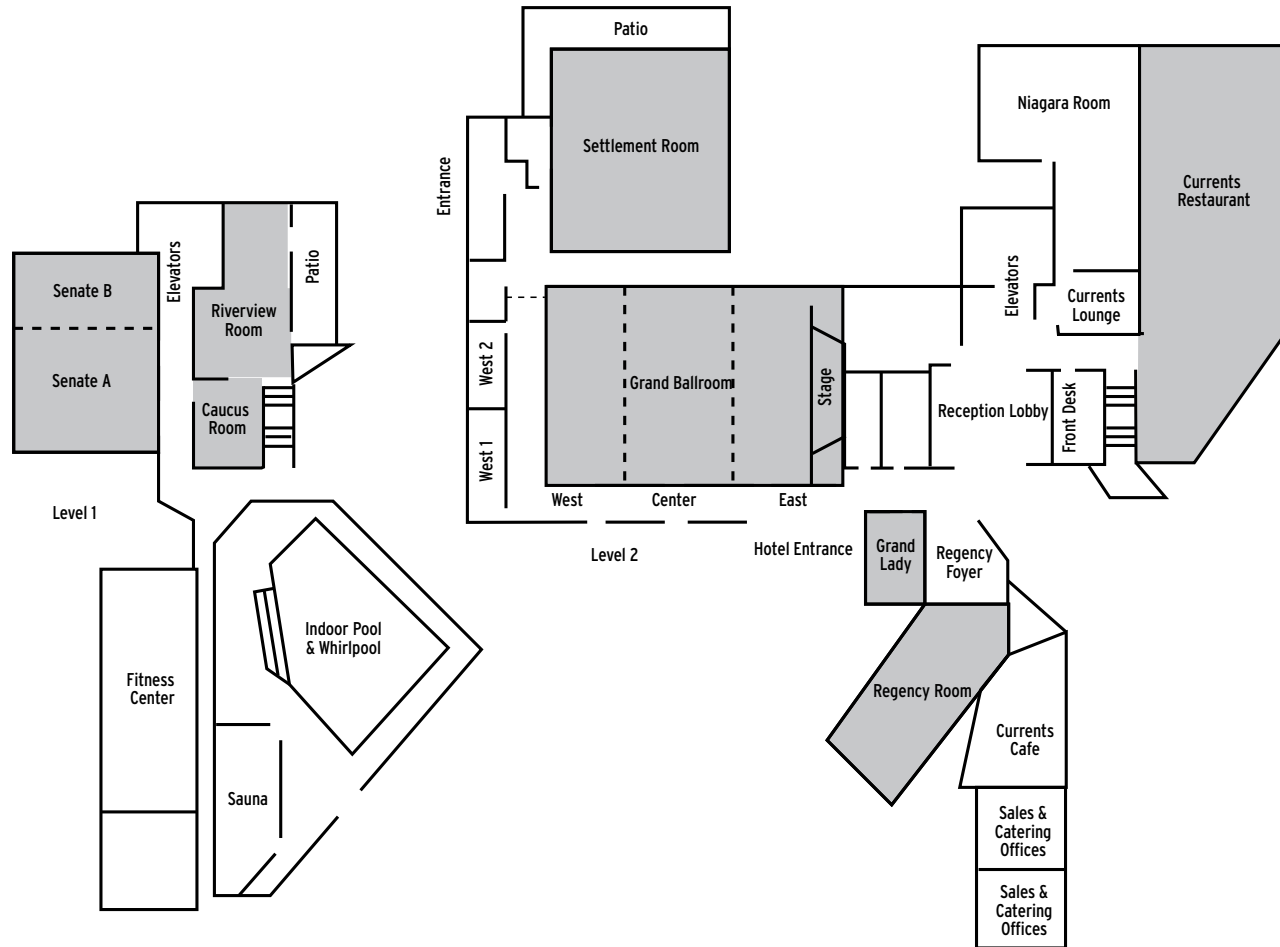

## Hotel Indigo

10 Flint Road • Amherst, NY 14226 • (716) 689-4414 • Fax: (716) 689-4382 • [www.hotelbuffaloamherst.com](http://www.hotelbuffaloamherst.com)

- 181 guest rooms & suites
- 3 meeting rooms
- Largest seating capacity: 75
- Banquet seating capacity: 80
- Airport transportation available
- Bar and restaurant on site
- Health club on site
- Adjacent to the University at Buffalo, Niagara Falls and shopping centers
- Meeting and catering facilities available accommodating up to 80 people
- Coffee makers, hair dryers, irons and boards
- Alarm clocks with MP3 hookup
- Wireless high speed Internet throughout hotel
- Indoor heated swimming pool & spa
- State of the art fitness center
- Golden Bean Café, room service available
- Phi Lobby Bar
- State of the art AV equipment
- Professional staff to service events
- Affordable Meeting Packages to meet your needs

ROOM	THEATRE DIMENSIONS	CLASSROOM SEATING	BANQUET SEATING	SEATING
DaVinci	576 sq. ft.	50	20	50
Fibonacci	576 sq. ft.	50	20	50
Nautilus	1116 sq. ft.	75	40	80

## Hotel Indigo meeting amenities

### BUSINESS SERVICES

- Copying
- E-mail & Internet
- Facsimile
- PC available
- Printer
- Unstaffed Business Center
- Analog Dial-up Service Available
- High Speed Internet Access
- Complimentary Wireless Data Connection
- Secretarial Services

### MEETING ROOMS

- 3 Meeting Rooms
- 2268 sq. ft. of Meeting Space
- Largest Room Capacity: 130 Reception Style
- Largest Room Measurements: 36 sq. ft. x 31.0 sq. ft.  
(ceiling height = 9 sq. ft.)
- Smallest Room Capacity: 12 Boardroom Style
- Smallest Room Measurements: 24 sq. ft. x 24 sq. ft.  
(ceiling height = 8 sq. ft.)

### EQUIPMENT

- 35mm Slide Projector
- DVD Player
- Flip Chart and Markers
- LCD Projector
- Lectern
- Microphone
- Modem Lines
- Overhead Projector
- VCR
- Whiteboard

## Millennium Airport Hotel Buffalo

2040 Walden Avenue • Buffalo, NY 14225 • Sales: (716) 206-8316 • Catering: (716) 206-8317 • [www.millenniumhotels.com/buffalo](http://www.millenniumhotels.com/buffalo)

- 300 guest rooms
- 12,000 square feet of meeting space
- Directly adjacent to Walden Galleria Mall, at Exit 52E of NYS Thruway (I-90), 15 minutes from downtown
- Tropical Courtyard with indoor pool, Gazebo Bar and retractable domed roof
- Bi-level suites; oversized courtyard rooms with interior balconies; Jacuzzi mini-suites
- Exercise room and his n' her saunas
- All sleeping rooms equipped with high-speed Internet access, voice mail, coffee makers, hair dryers and two phones
- 24 hour business center and ATM
- Free parking and airport shuttle
- Waldens Restaurant for breakfast, lunch and dinner
- Multi-level Twigs Lounge for snacks, cocktails and entertainment

ROOM	DIMENSIONS	THEATRE SEATING	CLASSROOM SEATING	BANQUET SEATING	SQUARE FEET
<b>Presidential Ballroom</b>	105' x 60'	700	360	600	6,300'
<b>Cleveland, Fillmore, Roosevelt</b>	60' x 35'	225	120	170	2,100'
<b>Roosevelt A, B or C</b>	35' x 20'	60	30	50	700'
<b>McKinley</b>	35' x 40'	120	60	80	1,400'

ROOM	DIMENSIONS	THEATRE SEATING	CLASSROOM SEATING	BANQUET SEATING	SQUARE FEET
<b>Reception Alcove</b>	25' x 36'	900	100	N/A	900'
<b>Upper Courtyard</b>	N/A	70	24	90	
<b>Lower Courtyard</b>	N/A	130	40	170	
<b>Governors</b>	24' x 18'	30	20	40	432'
<b>Kennedy</b>	38' x 20'	100	48	60	760'
<b>Parlour</b>	24' x 26'	45	28	50	624'

# Millennium Airport Hotel Buffalo floor plan

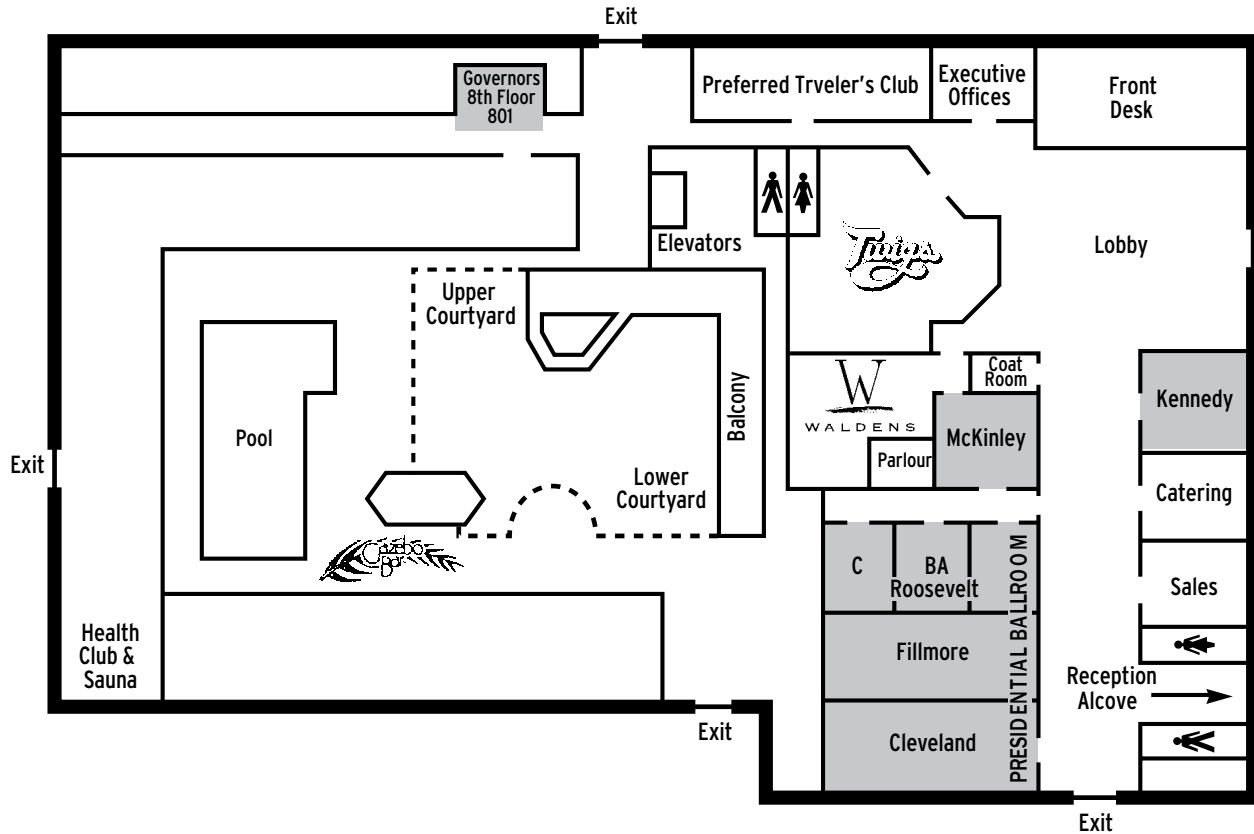

## Ramada Hotel & Conference Center

2402 North Forest Road • Amherst, NY 14226 • (716) 636-7500 or 800-537-8483 • Fax: (716) 636-8296 • [www.ramadahotelamherst.com](http://www.ramadahotelamherst.com)

- 120 guest rooms
- 14 meeting rooms
- Largest seating capacity: 400
- Banquet seating capacity: 275
- Complimentary airport shuttle and breakfast
- Bar and restaurant on site
- Fitness room and running track on site
- Adjacent to University at Buffalo, 20 minutes from downtown, 10 minutes from airport
- Soundproof conference rooms with state-of-the-art audiovisual equipment
- Focus group complex with videotaping equipment and one-way mirrors
- Professional conference planners, concierge and support services
- All sleeping and meeting rooms wired for high-speed internet access
- Bar/lounge and ★★½ restaurant for fine dining
- Patio dining available
- 14-acre complex with trails for hiking, jogging and biking

ROOM	DIMENSIONS	THEATRE SEATING	CLASSROOM SEATING	BANQUET SEATING	SQUARE FEET
Buffalo A	23' x 13'	30	20	25	299'
Buffalo B	23' x 13'	30	20	25	299'
Buffalo a & B	23' x 26'	65	40	50	598'
Niagara	18' x 21'	35	25	30	378'
Focus Meeting	12' x 25'	30	20	20	300'
Focus Viewing	13' x 15'	20	N/A	N/A	195'
Ellicott	24' x 86'	170	75	150	2,064'
Grand Ballroom	48' x 85'	300	200	250	4,080'

ROOM	DIMENSIONS	THEATRE SEATING	CLASSROOM SEATING	BANQUET SEATING	SQUARE FEET
Empire State	24' x 12'	30	20	20	288'
University Suite A	17' x 23'	35	20	20	391'
University Suite B	23' x 23'	60	30	30	529'
University Suite C	19' x 23'	40	30	30	437'
University Suite D	19' x 23'	60	30	25	437'
University Suite E	20' x 23'	40	30	25	460'
University Suites B & C	43' x 23'	100	65	60	989'
University Suites D & E	39' x 23'	100	65	50	897'

*Floor plans on the other side of this page*

## Ramada Hotel & Conference Center floor plans

